

# METEOR

MANUAL

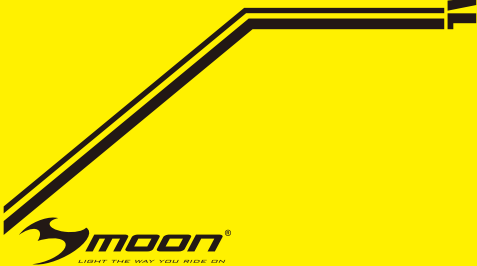

Read this manual carefully before using and keep for future reference. Visit [www.moon-sport.com](http://www.moon-sport.com) for manual updates.

## FEATURES

- 1 XPG2 high brightness LED
- Rechargeable lithium polymer battery (3.7V 1200mAh)
- Mode memory function
- Day flash mode
- 4 steady modes, 4 flashing modes
- Quick release universal bracket (fits all round and AERO style bars)
- Mode indicator
- Battery capacity and charging indicator
- Automatic fully charged cut-off system
- High precision optical lens
- Recharge time 2.5hrs
- Water resistant (IPX 4)

## CONTENTS

METEOR

RB-25 (Universal handlebar bracket)

USB-WP (Water resistant USB cable)

## Optional accessories:

RB-26 (Handlebar bracket)

RB-16 (Helmet bracket)

RB-28 (GoPro mount adapter)

XP-USC (Wall charger)

USB-RM-350 (USB remote control 350 mm)

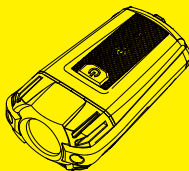

## OPERATION

1. Press power button to turn on the light.
2. Press power button to choose modes.
3. Double click power button to toggle between steady and flashing modes.
4. Press power button for 1 sec to turn off the light.

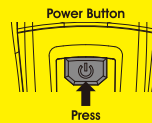

\* With Mode Memory Function: the light resumes previous mode upon next usage.

\* Remote switch operation is same as above.

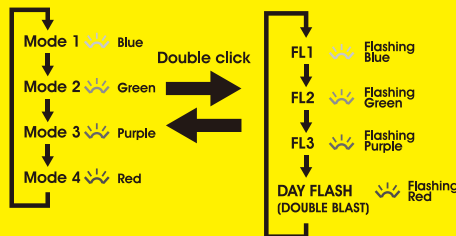

## RUNTIME

	Mode1	Mode2	Mode3	Mode4	FL1	FL2	FL3	DAY FL
LUMEN	300	200	100	50	20	100	*20/400	400
H:MIN	1:30	2:15	4:30	9:00	48:00	15:00	12:00	30:00
1M LUX	4000	2900	1410	690	/	/	/	/
2M LUX	980	680	330	160	/	/	/	/
10M LUX	40	30	15	7	/	/	/	/



\* FL3 is a steady-flashing mode. High lumen flashing plus low lumen steady beam for safety purpose.

## BATTERY CHARGING AND CARE

1. Turn off the light.
2. Lift the rubber cover.
3. Plug the USB cable into charging port.
4. Plug the USB cable to wall or computer USB socket.
5. Charging indicator will be on. Unplug the cable after fully charged.

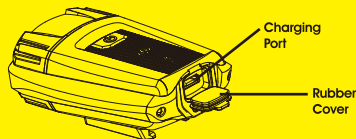

## BATTERY CARE

- \* Do not charge over 5V, the battery will result in damage.
- \* Keep away from flammable objects while charging as this may lead to fire or battery explosion.
- \* Battery may get high temperatures during charging (up to 104°F/40°C).
- \* The battery capacity may become ineffective about 80% of its value after 300charge/discharge cycles.
- \* The battery voltage and capacity decrease apparently at low temperatures, especially near or below ice point. The capacity decreases 5%-10% at freezing (burn time decreases 50%). At -20°C, the capacity decreases 30% (burn time decreases 70%). The battery performance will return normal when the temperature gets up to 70°F/20°C.
- \* Keep the battery in cool and dry place when storing. Recharge the battery fully at least every 3 months.

## BATTERY CAPACITY AND CHARGING INDICATOR

Battery indicator

- 100% - 60% Blue
- 60% - 20% Green
- 20% - 0% Flashing Red

8 Modes indicator

Power button

Charging indicator

- Flashing blue - charging
- Solid blue - charged

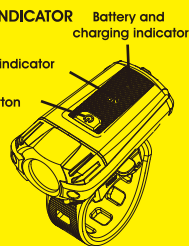

## HANDLEBAR MOUNTING

1. Install the bracket onto handlebar by wrapping rubber strap around post/bar and stretching strap around hook to secure.
2. Slide headlight forward onto bracket until it clicks into place.
3. Press down release lever to remove.

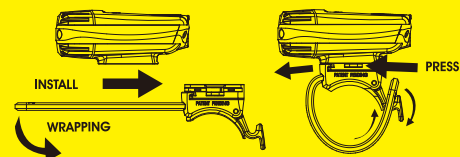

## HELMET MOUNTING (Optional)

1. Wrap belt around helmet and return the belt onto slotted space.
2. Twist screw knob clockwise until tight.
3. Slide headlight forward onto bracket until it clicks into place.
4. Press down release lever to remove.
5. To adjust the vertical beam angle when mounted on the helmet, loosen the screw knob and rotate the light up or down to your preferred angle, then tighten the screw knob to secure the light in.

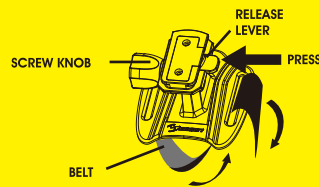
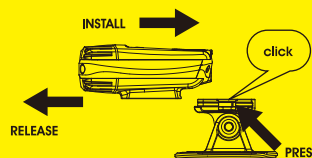

## WARNING

- \* Understand country lighting laws and regulations before use.
- \* Do not shine directly in the eyes.
- \* Light may get hot when in use.
- \* Adjust the angle downward to prevent from blinding the oncoming vehicles on the public roads.
- \* Do not submerge the battery or the whole light into water.
- \* Unplug the light, charger and cable once the battery is fully charged.
- \* Do not dismantle the light which will void warranty.
- \* Do not leave the light on and unattended.
- \* Keep the light away from fire and combustible materials.
- \* Do not store head unit when hot or straightway after use.

## WARRANTY

MOON Lights are covered by a ONE YEAR LIMITED WARRANTY from the date of purchase is free from defects in material and workmanship. This warranty does not apply to damage due to heat, physical damage resulting from abuse, neglect, improper repair, improper fit, or alterations of the fixture. This covers the lights and cables only. Batteries are covered by 120 days warranty not including battery normal wear.

All customers should contact the local dealer or regional distributor for warranty service. To make a claim, first contact original dealer or distributor. Some issues may be resolved upon the initial call. If return of the product is necessary, use traceable method such as FedEx or UPS. MOON is not responsible for lost or misdirected packages.

Please include your full contact information (name, address, phone number, and email [if applicable]), and a description of the issue.

For more information please contact us at [cs@moon-sport.com](mailto:cs@moon-sport.com).